

REV:	ECN. NO.	NAME	DATE

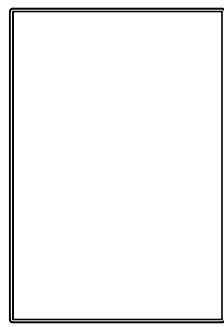

TOP VIEW

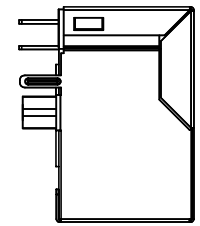

LEFT SIDE VIEW

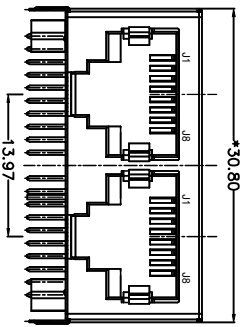

FRONT VIEW

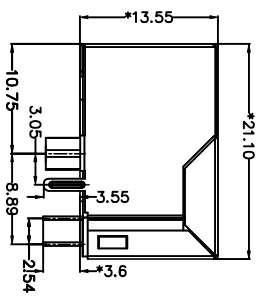

RIGHT SIDE VIEW

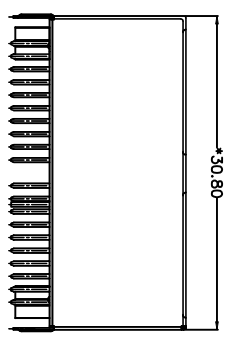

BACK VIEW

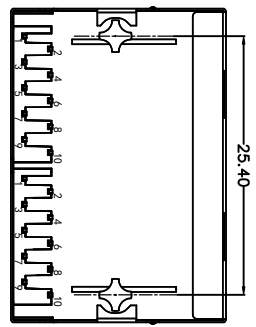

BOTTOM VIEW

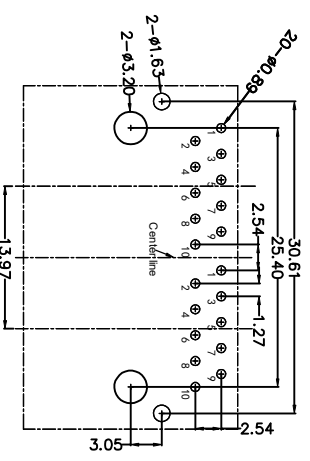

RECOMMENDED PCB LAYOUT
VIEWED FROM COMPONENT SIDE

MATERIAL:
 HOUSING: PBT,UL94V-0,BLACK.
 TERMINALS BRACKET: PBT,UL94V-0,BLACK.
 SHIELD: C2680,T=0.20MM,NICKEL PLATING ON ALL AREA.
 TERMINAL: PHOSPHOR BRONZE C5210,T=0.35MM,
 6U" GOLD PLATING ON CONTACT AREA.

MECHANICAL:
 DURABILITY: 750 CYCLES MIN.
 MATING FORCE: 23N MAX.
 OPERATING TEMPERATURE: -40°C~+85°C.
 STORAGE TEMPERATURE: -40°C~+85°C.
 ALL CRITICAL DIMENSIONS WITH "**"

RoHS Compliant



FOR YOUR
VITAL CONNECTION

TOLERANCE UNSPECIFIED	.0	±0.38	TITLE:	TAB-DOWN 1X2 2.5G
	.00	±0.25		
ANGLE	.000	±0.10		
MANUFACTURING COPY				
DRAWN BY:	Zou Long	PART NO:	J12GK1003NPA01	REV: A
CHECKED BY:	Bob	SIZE: A4		
APPROVED BY:	QPF	PROJECTION		



SHEET: 1 OF 4 FCN: A0

<http://www.vitalconn.com>

REV:	ECN. NO.	NAME	DATE

RECOMMENDED PANEL CUTOUT (REFERENCE ONLY) :

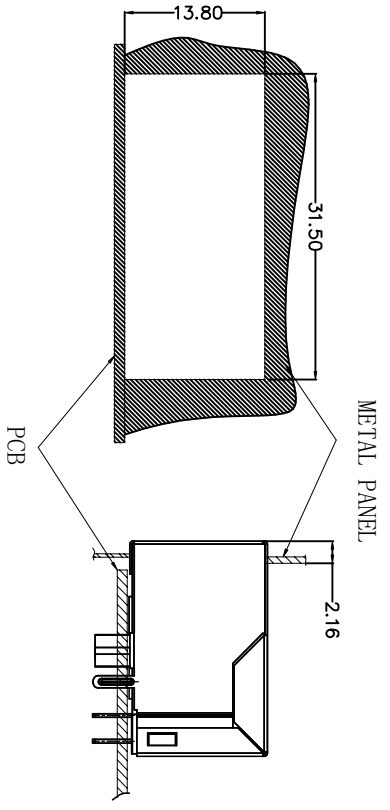

UNIT: MM / INCH
 TOLERANCES: ± 0.10 / 0.004
 REFERENCE ONLY

KEEP-OUT AREA (COMPONENT SIDE VIEW) :

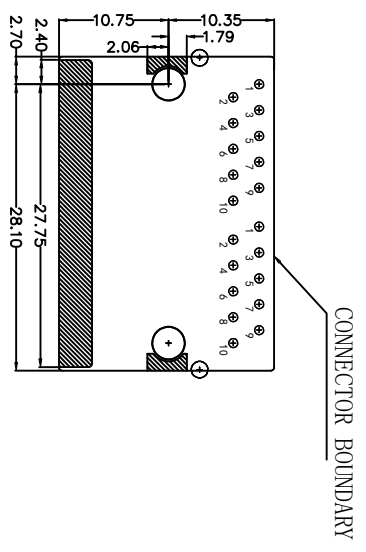

UNIT: MM / INCH
 TOLERANCES: ± 0.10 / 0.004

RoHS Compliant



FOR YOUR
 VITAL CONNECTION

TOLERANCE UNSPECIFIED
 .0 ±0.38
 .00 ±0.25
 .000 ±0.10
 ANGLE ±3.00°
 MANUFACTURING COPY

TITLE: TAB-DOWN 1X2 2.5G

DRAWN BY:	Zou Long	PART NO:	J12GK1003NPA01	REV: A
CHECKED BY:	Bob	SIZE: A4	UNIT:mm	SHEET:2 OF4
APPROVED BY:	QPF	PROJECTION	FCN: A0	http://www.vitalconn.com

1	2	3	4
---	---	---	---

5	6	7	8
---	---	---	---

REV:	ECN. NO.	NAME	DATE

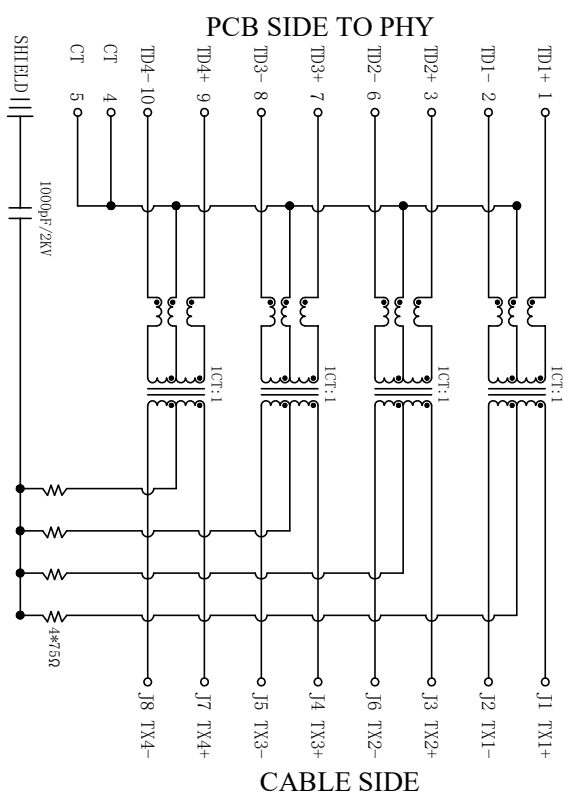

Electrical:

1. Turn ratio: 1~2: J1~J2=1CT:1CT(±2%).
3~6: J3~J6=1CT:1CT(±2%).
7~8: J4~J5=1CT:1CT(±2%).
9~10: J7~J8=1CT:1CT(±2%).
2. OCL: 180uH Min. @ 100KHz 0.1V.
3. Insertion Loss: -1.0 dB Max 1~125MHz.
4. Return loss: -20dB Min 1~40MHz;
-20+15LOG₁₀(f/40MHz) Min 40~200MHz.
5. Cross talk: -30dB Min 1~125MHz.
6. CMR: -30dB Min 30~200MHz;
7. Hi-Pot: 2250V DC 6S 1mA PRI TO SEC

ROHS Compliant



FOR YOUR
VITAL CONNECTION

TOLERANCE UNSPECIFIED
 .0 ±0.38
 .00 ±0.25
 .000 ±0.10
 ANGLE ±3.00°
 MANUFACTURING COPY

TITLE: TAB-DOWN 1X2 2.5G

DRAWN BY: Zou Long PART NO: J12GK1003NPA01 REV: A

CHECKED BY: Bob SIZE: A4 UNIT:mm SHEET:3 OF 4 FCN: A0

APPROVED BY: QPF PROJECTION <http://www.vitalconn.com>

PROFILE OF WAVE SOLDER

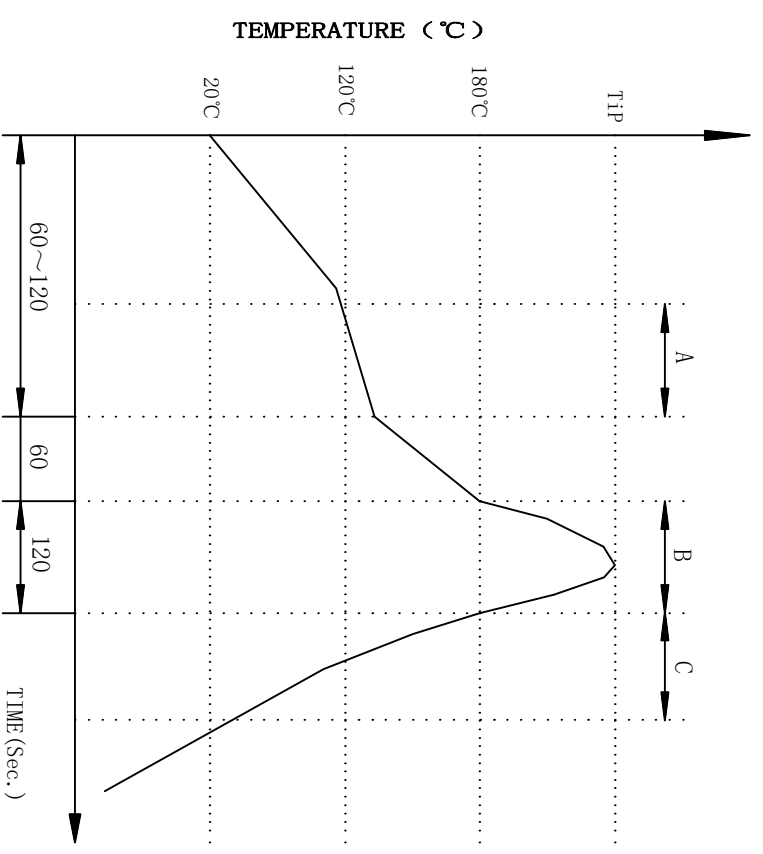

A:Preheating B:Soldering C:Gradual Cooling
 Tip temperature:260±5°C.
 Tip temperature time:5Sec Max.
 Tip melting point of Sn96.5/Ag3/Cu0.5:217°C.

Remarks: after wave soldering, the plastic positioning columns of the product which under the POB will be slightly melted, but it won't affect its function.

REV:	ECN. NO.	NAME	DATE

ROHS Compliant



FOR YOUR
VITAL CONNECTION

TOLERANCE UNSPECIFIED
 .0 ±0.38
 .00 ±0.25
 .000 ±0.10
 ANGLE ±3.00°
 MANUFACTURING COPY

TITLE: TAB-DOWN 1X2 2.5G

DRAWN BY: Zou Long PART NO: J12GK1003NPA01 REV: A

CHECKED BY: Bob SIZE: A4 UNIT:mm SHEET:4 OF 4 FCN: A0

APPROVED BY: QPF PROJECTION <http://www.vitalconn.com>